



audio-technica

AT-CSP5

Speakerphone

User Manual

English

Safety precautions

Although this product was designed to be used safely, failing to use it correctly may result in an accident. To ensure safety, observe all warnings and cautions while using the product.

Cautions for the product

- Do not use the product near medical equipment. Radio waves may affect cardiac pacemakers and medical electronic equipment. Do not use the product inside medical facilities.
- Do not use the product near automatic control devices such as automatic doors and fire alarms. Radio waves may affect electronic equipment and cause accidents due to malfunction.
- Do not disassemble, modify or attempt to repair the product to avoid electric shock, malfunction or fire.
- Do not subject the product to strong impact to avoid electric shock, malfunction or fire.
- Do not handle the product with wet hands to avoid electric shock or injury.
- Disconnect the product from a device if the product begins to malfunction, producing smoke, odor, heat, unwanted noise or showing other signs of damage. In such a case, contact your local Audio-Technica dealer.
- Do not allow the product to get wet to avoid electric shock or malfunction.
- Do not put foreign matter such as combustible materials, metal, or liquid in the product.
- Do not cover the product with a cloth to avoid fire or injury by overheating.
- Charge only with the included USB cable to avoid malfunction or fire.
- Do not charge with devices that have quick-charge functionality (with a voltage of 5 V or more). Doing so may cause the product to malfunction.
- To prevent damage to your hearing, do not raise the volume too high. Listening to loud sound for an extended period may cause temporary or permanent hearing loss.
- Do not place the product on an unstable location because that could cause the product to fall and become damaged or cause injury.
- Do not store the product in direct sunlight, near heating devices, or in hot, humid, or dusty places because such storage could cause malfunction or defect.
- Do not put the product close to fire because that could cause deformation or malfunction.
- Do not use benzine, paint thinners and electrical contact cleaner, etc. because use of such material could cause deformation or malfunction.

Cautions for rechargeable battery

The product is equipped with a rechargeable battery (lithium ion battery).

- If battery fluid gets into eyes, do not rub them. Rinse thoroughly with clean water such as tap water and consult a doctor immediately.
- If battery fluid leaks, do not touch fluid with bare hands. If fluid remains inside the product, it may cause malfunction. If battery fluid leaks, contact your local Audio-Technica dealer.
 - If fluid gets in your mouth, gargle thoroughly with clean water such as tap water and consult a doctor immediately.
 - If your skin or clothing comes in contact with fluid, immediately wash the affected skin or clothing with water. If you experience skin irritation, consult a doctor.

Safety precautions

- To avoid leakage, generation of heat or explosion:
 - Never heat, disassemble or modify the battery, nor dispose of it in a fire.
 - Do not attempt to pierce with a nail, hit with a hammer or step on the battery.
 - Do not drop the product or subject it to strong impact.
 - Do not get the battery wet.
- Do not use, leave or store the battery in the following places:
 - Area exposed to direct sunlight or high temperatures and humidity
 - Inside of a car under the blazing sun
 - Near heat sources such as heat registers
- Charge only with the included USB cable to avoid malfunction or fire.
- The internal rechargeable battery of this product cannot be replaced by the user. The battery may have reached the end of its service life if the usage time becomes significantly shorter even after the battery has been fully charged. If this is the case, the battery needs to be repaired. Contact your local Audio-Technica dealer for repair details.
- When the product is disposed of, the built-in rechargeable battery needs to be discarded properly. Contact your local Audio-Technica dealer to learn how to properly dispose of the battery.

Notes on use

- Be sure to read the connected device's user manual before use.
- Audio-Technica will not be liable in any way for any loss of data in the unlikely event that such losses should occur while using the product.
- Minimize the volume on your device before connecting the product.
- Do not subject the product to strong impact.
- Do not store the product in direct sunlight, near heating devices, or in hot, humid, or dusty places. Additionally, do not allow the product to get wet.
- When the product is used for a long time, the product may become discolored due to ultraviolet light (especially direct sunlight) and wear.
- Make sure to hold the plug when connecting and disconnecting the USB cable. The USB cable may become severed or an accident may occur if you pull on the cable itself.
- When you are not using the USB cable, disconnect it from the product.
- Do not charge the battery if the terminal of the USB cable is bent, loose, or damaged. Doing so may cause heat generation, smoke emission, fire or electric shock.
- When you are not using the product, store it in the included case.
- If you use the product near an electronic device or transmitter (such as a mobile phone), unwanted noise may be heard. In this case, move the product away from the electronic device or transmitter.
- If you use the product near a TV or radio antenna, noise may be seen or heard in the television or radio signal. In this case, move the product away from the TV or radio antenna.
- Do not place items sensitive to magnetism (such as cash cards) near the product. Doing so may cause negative effects to those items.
- Do not place the product directly on delicate materials such as marble or unfinished wood.
- Ensure the plug is fully inserted.
- To protect the built-in rechargeable battery, charge it at least once every 6 months. If too much time passes between charges, the life of the rechargeable battery may be reduced, or the rechargeable battery may no longer be able to be charged.
- Do not connect the connector jack or USB cable if water or foreign matter is found inside. Doing so may cause corrosion, heat generation, smoke emission, fire, or electric shock in the connector jack or USB cable.
- Charge the product in a well-ventilated place (10 to 35°C (50 to 95°F)) away from direct sunlight. Otherwise, the battery may deteriorate, possibly resulting in shorter periods of continuous use or may fail to charge.
- Operate the touch sensor with one finger. Operating with a sharp-tipped object, such as a ballpoint pen or pencil, may result not only in incorrect operation, but also damage to the touch sensor.
- Do not touch the touch sensor with your fingertips. Doing so may cause your fingernail to break.
- If the product does not operate at all or as intended when touched, check to make sure that your other fingers, parts of your hand, or clothing items are not in contact when touching. Also, the product may not operate correctly if you are wearing gloves or if your fingers are too dry.
- The product may not operate correctly if the touch sensor is dirty from sweat. Remove the dirt before operating the product.
- This product can only be used in compliance with the radio laws of each country and in countries in which it has been certified. It cannot be used in countries other than where it was sold.

Part names and functions

Main unit (front/rear)

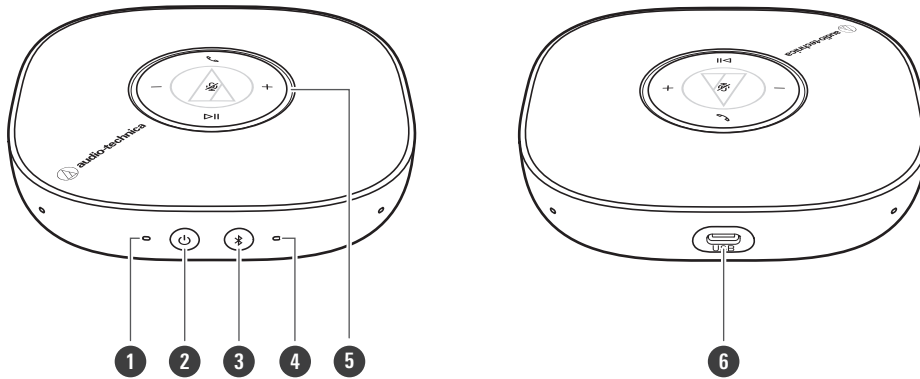

- 1 Power indicator lamp**
Lights in white when the power is on.
- 2 Power button**
Turns the product power on/off.
- 3 Pairing button**
Used when connecting via Bluetooth.
- 4 Pairing indicator lamp**
Displays the Bluetooth connection status.
- 5 Status indicator lamp**
Displays the product status.
- 6 Connector jack**
Used to connect the included USB cable.

Main unit (touch sensors)

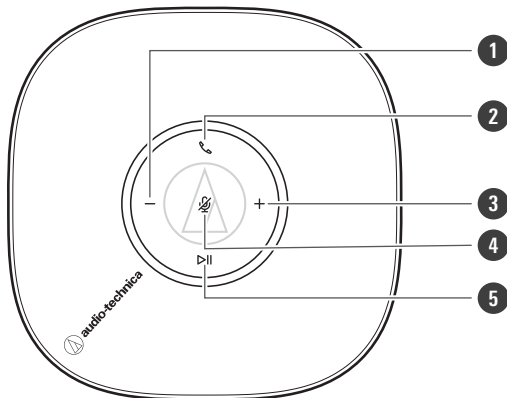

- 1 Volume button (-)**

Part names and functions

2 Talk button

Use to answer a phone call when connected via Bluetooth.

3 Volume button (+)

4 Mute button

5 Play/pause button

Use to play/pause music, and to select the next track or previous track.

Included accessories

1

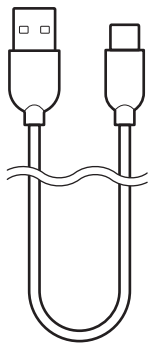

2

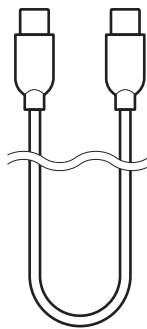

3

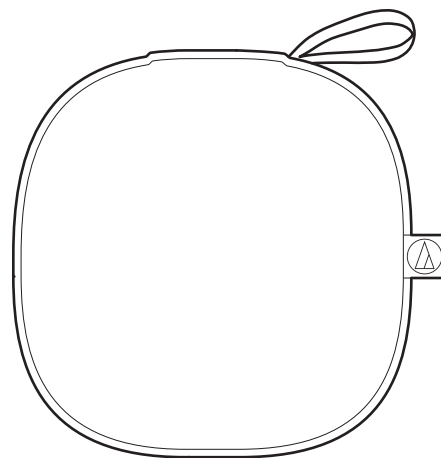

1 USB cable (1.0 m (3.3'), USB Type-A - USB Type-C™)

2 USB cable (1.0 m (3.3'), USB Type-C - USB Type-C™)

3 Case

Connection methods

There are two connection methods: USB connection and Bluetooth connection. Select according to the device which you will use.

USB connections

Use the included USB cable (USB Type-A - USB Type-C) or USB cable (USB Type-C - USB Type-C) to connect the product to a computer.

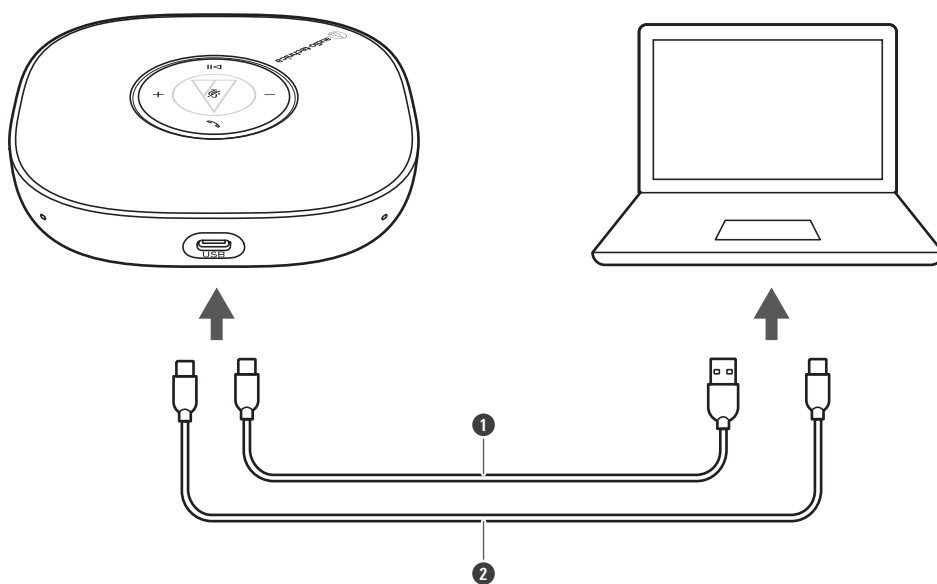

- 1 USB cable (USB Type-A - USB Type-C)
- 2 USB cable (USB Type-C - USB Type-C)



- USB can be used to connect to a computer only.

Bluetooth connections

- This product can be used by pairing with a Bluetooth device (such as a PC, tablet, or smartphone).
- It is not possible to connect this product to multiple Bluetooth devices at the same time.

Connection methods

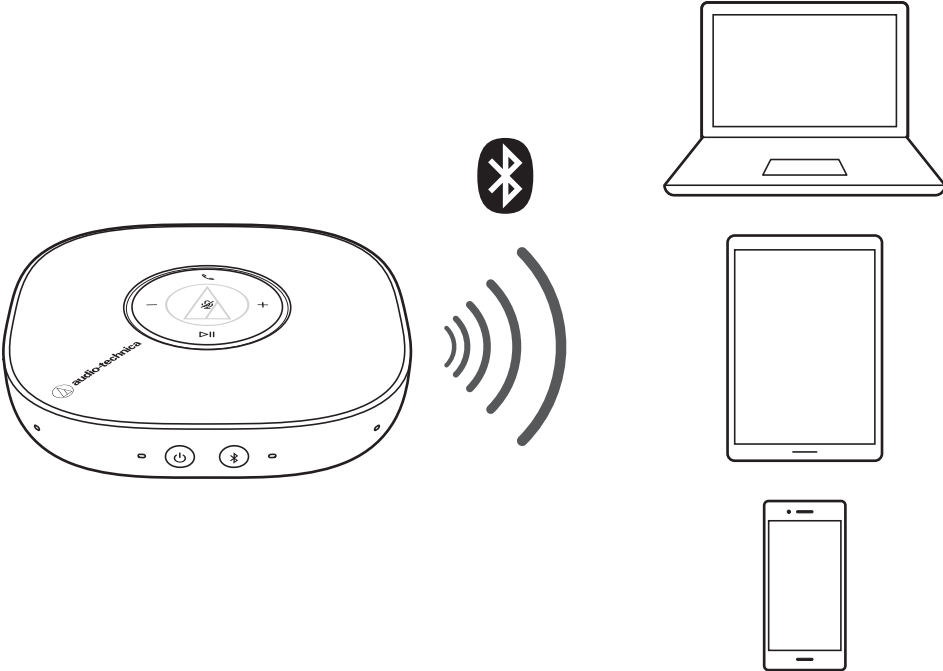

Charging the battery

- Fully charge the battery when using for the first time.
- When the rechargeable battery is running low, the voice guidance will play the message “Low battery”, and the power indicator lamp will flash in red. Charge the battery as soon as possible.
- It takes about 5 hours to charge the battery fully. (This time may vary depending on usage conditions.)
- Charge the product in a well-ventilated place (10 to 35°C (50 to 95°F)) away from direct sunlight. Otherwise, the battery may deteriorate, possibly resulting in shorter periods of continuous use or may fail to charge.
- Select and use either the USB cable (USB Type-A - USB Type-C) or the USB cable (USB Type-C - USB Type-C) according to the terminal on the connected device.

1 Connect the included USB cable (USB Type-C) to the product’s connector jack.

- The included USB cable is designed for exclusive use with the product. Do not use any other USB cable.
- When inserting the USB cable into the USB port or connector jack, insert it straight (horizontally).

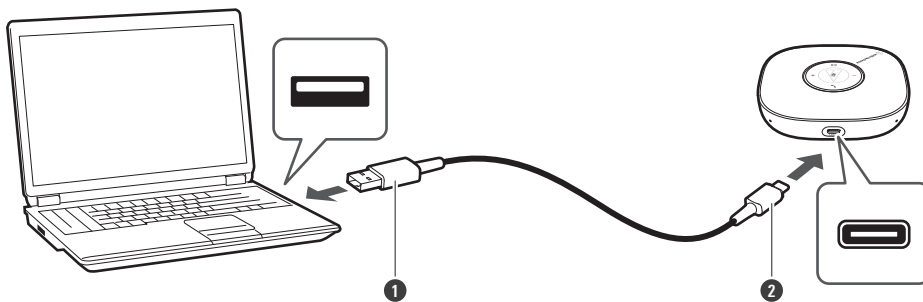

- ❶ USB Type-A or USB Type-C
- ❷ USB Type-C

2 Connect the included USB cable to the computer to start charging.

- While charging, the power indicator lamp lights as follows.

Status	Indicator lamp
Charging (power ON)	Lights in white
Charging completed (power ON)	Lights in white
Charging (power OFF)	Lights in red
Charging completed (power OFF)	Off

3 When charging is complete, disconnect the USB cable from the computer.

4 Disconnect the USB cable from the product connector jack.



- When the USB cable is connected to the computer, the product power turns on automatically. When the product will not be used, press and hold the power button (for about 2 seconds) to turn off the power.
- If a commercially available AC adapter is used for charging, the power will not turn on.

Charging the battery



- Be sure to use the included USB cable for charging. The product may not charge with cables other than the included USB cable.
- When charging using a computer USB port, depending on the computer that you are using, the computer may not be usable because it is unable to supply sufficient power for charging.
- When using a commercially available AC adapter, use a product with a rated current of 1.3 A or higher. Otherwise there is the risk of the AC adapter overheating or of malfunction. In addition, correct charging may not be possible.

Checking the battery level

When the power is on, press the power button to display the battery level.

1 Turn on the power and then press the power button.

- The status indicator lamp lights as follows. The battery level is indicated by the length of the status indicator lamp, which lights in white in a circle.

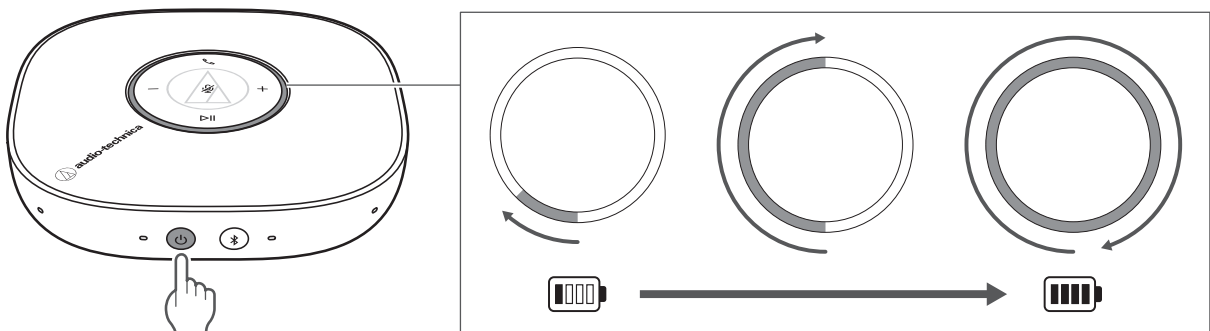

Turning the power on/off (USB connection)

Turning on the product

1 Connect the included USB cable to the product's connector jack.

- Select and use either the USB cable (USB Type-A - USB Type-C) or the USB cable (USB Type-C - USB Type-C) according to the terminal on the connected device.

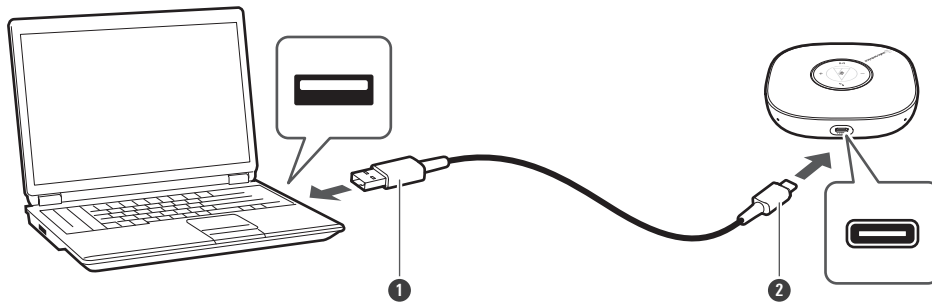

- ① USB Type-A or USB Type-C
- ② USB Type-C

2 Connect the included USB cable to the computer.

- » The voice guidance plays the message "Power on, USB mode", the power automatically turns on, and the power indicator lamp lights in white. The status indicator lamp first lights in green and then turns off.

Turning off the product

1 Disconnect the included USB cable from the computer, and then disconnect it from the product.

- » The voice guidance plays the message "Power off", the power automatically turns off, and the power indicator lamp turns off. The status indicator lamp first lights in green and then turns off.

Turning the power on/off (Bluetooth connection)

Turning on the product

Disconnect the USB cable.

- 1 Press and hold the power button (for about 2 seconds).

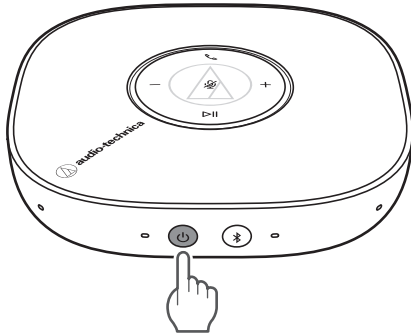

» The voice guidance plays the message "Power on, Bluetooth mode", the power turns on, and the power indicator lamp lights in white. The status indicator lamp first lights in green and then turns off.

Turning off the product

- 1 Press and hold the power button (for about 2 seconds).

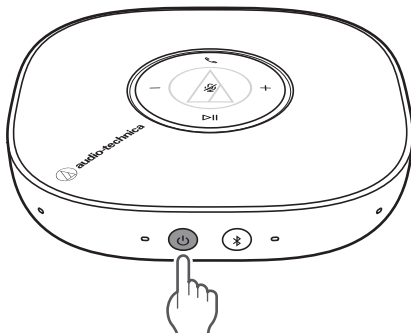

» The voice guidance plays the message "Power off", the power turns off, and the power indicator lamp turns off. The status indicator lamp first lights in green and then turns off.

Connecting via Bluetooth

To connect the product to a Bluetooth device, the product needs to pair (register) with the device.

Pairing a Bluetooth device

- Read the user manual for the Bluetooth device.
- Place the Bluetooth device within 1 m (3.3') of the product to perform pairing correctly.
- Disconnect the USB cable.

1 Turn on the product and press the pairing button.

- The voice guidance will play the message "Bluetooth pairing", and the pairing indicator lamp will flash in blue.

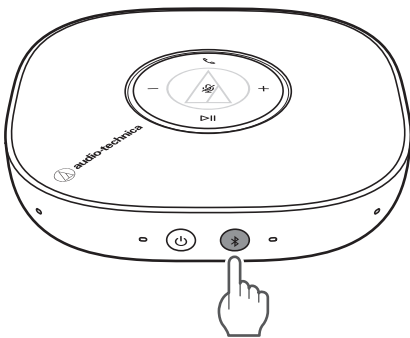

2 Use your Bluetooth device to begin the pairing process and search for the product. When your Bluetooth device finds the product, "AT-CSP5" will be displayed on the device.

- For information about using your Bluetooth device, refer to the device's user manual.

3 Select "AT-CSP5" and register it in the Bluetooth device that you will connect to.

- Some devices may ask for a passkey. In this case, enter "0000". The passkey may also be called a passcode, PIN code, PIN number, or password.

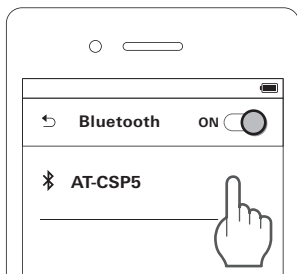

» The voice guidance will play the message "Bluetooth connected" when pairing is complete. The pairing indicator lamp lights in blue.



- Pairing is not possible when the USB cable is connected to the computer.
- If the USB cable is connected to the computer while Bluetooth is connected, the product switches to the USB connection.

About pairing

When connecting a new Bluetooth device, you need to pair it with the product. Once the Bluetooth device and the product are paired, you do not need to pair them again. The product supports multipairing, in which a connection history is saved. However, in the following cases you will need to pair again even if the Bluetooth device was paired once:

- If the product is deleted from the Bluetooth device's connection history.
- If the product is sent out for repair.
- If the product is reset.

Connecting

- After connecting it to the computer, check that the product is recognized and configured correctly.
- This section explains the operations which are the same for a USB connection and Bluetooth connection.

For Windows 10

When connected by USB, the computer automatically recognizes the product and the driver is installed on the computer. In the lower right part of the screen, a message appears indicating that new hardware has been found or a notification appears that the driver software has been installed.

1 Click "Start Menu" and select "Settings".

2 Select "System".

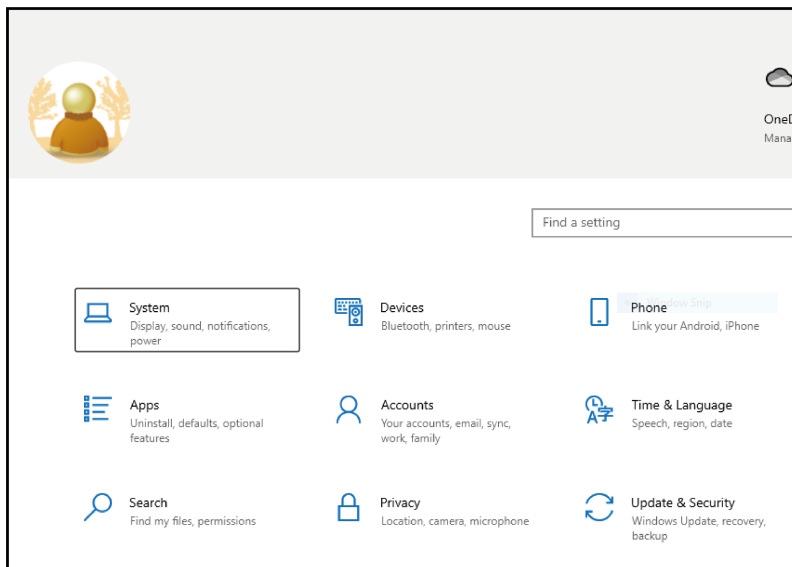

3 Select "Sound".

Connecting

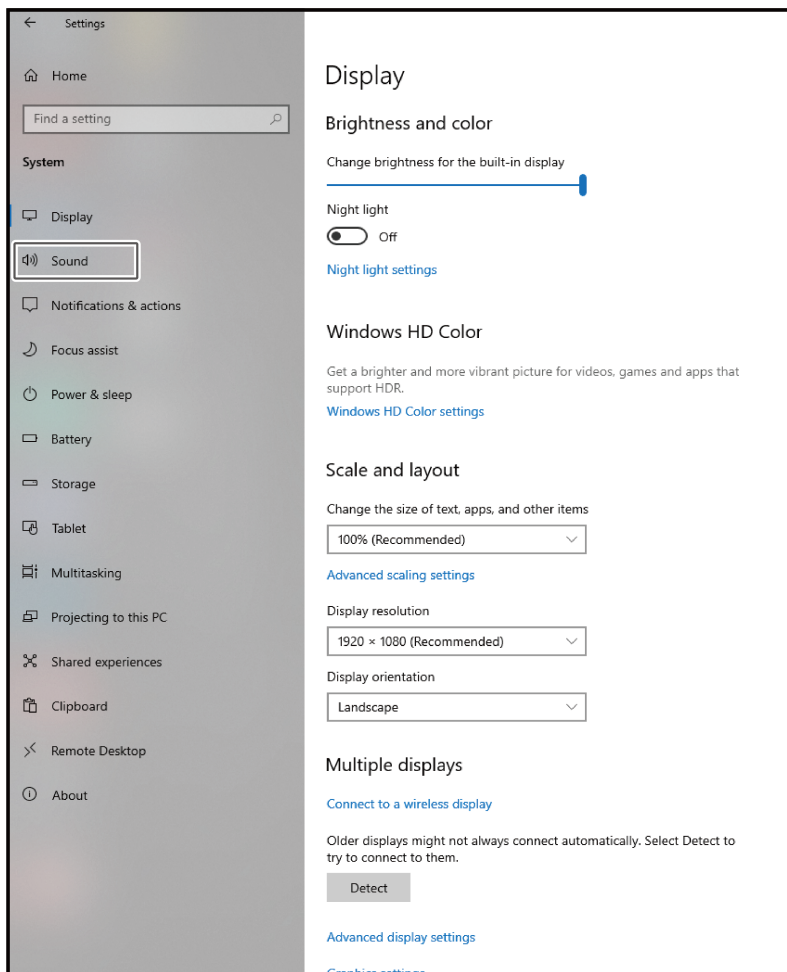

4 In the “Output” and “Input” fields, confirm that the product is selected.

- If the product is not selected, select the product from either “Choose your output device” or “Choose your input device”.

Connecting

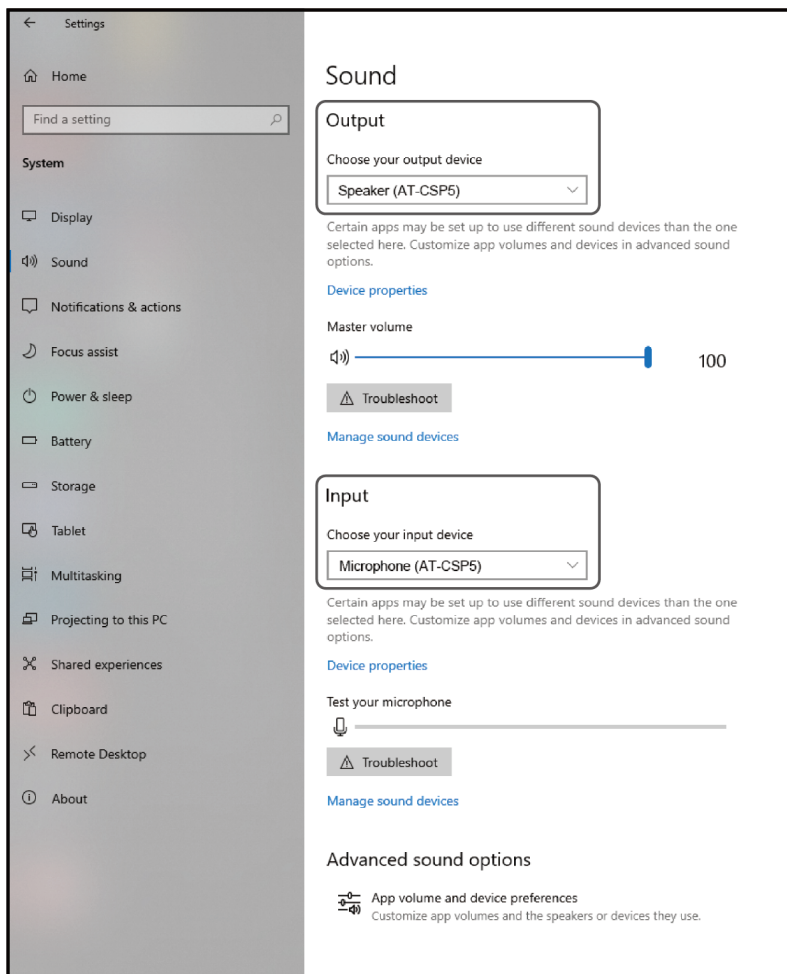

For macOS Big Sur

When connected by USB, the computer automatically recognizes the product and the driver is installed on the computer.

- 1** From the Apple icon, select "System Preferences".
- 2** Select "Sound".

Connecting

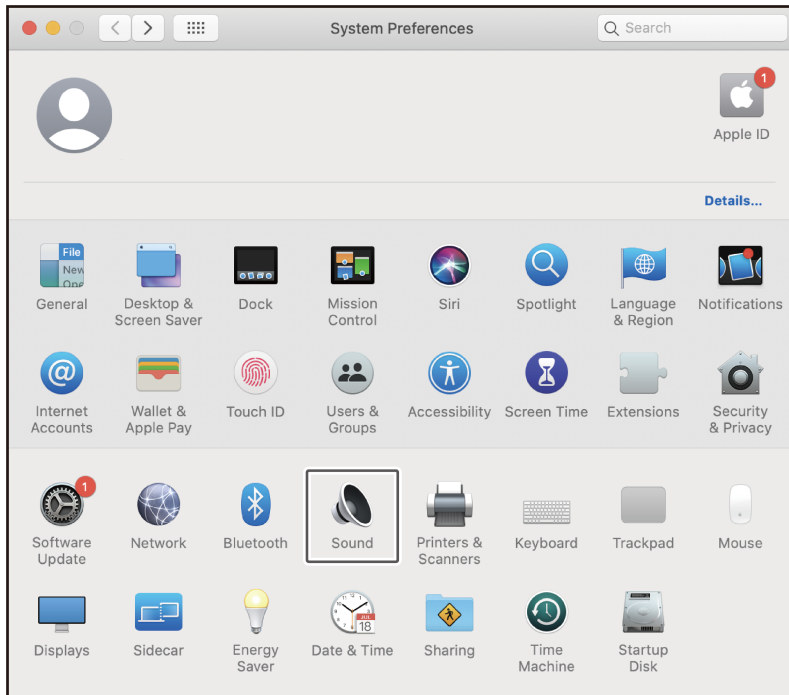

3 In the "Output" tab, confirm that the product is selected.

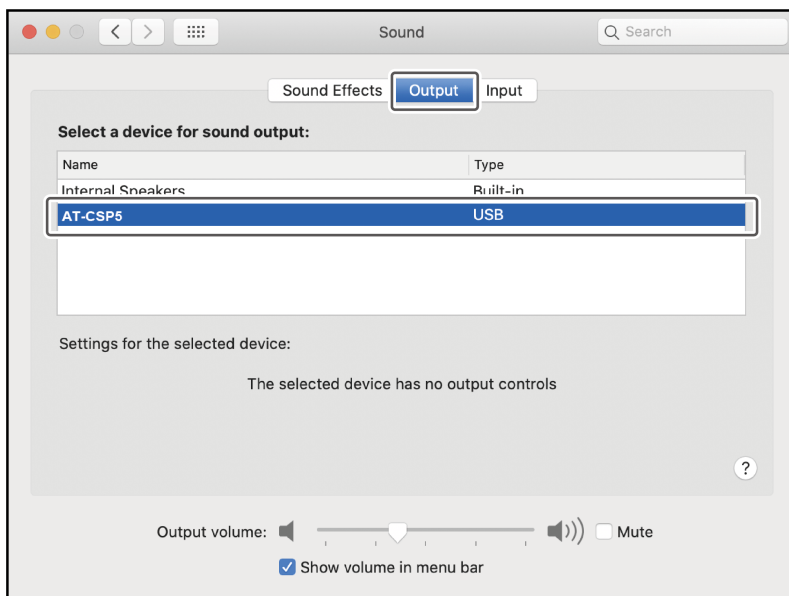

4 In the "Input" tab, confirm that the product is selected.

Connecting

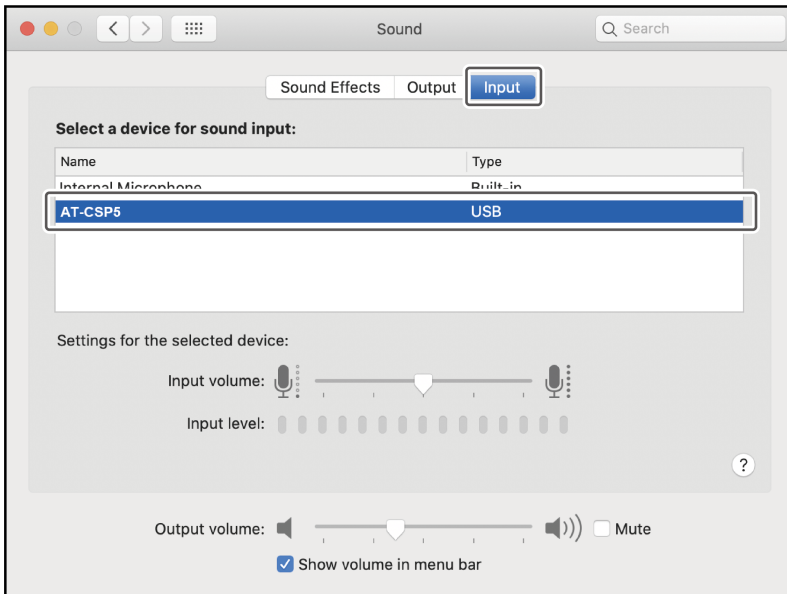

Using the product

- The product can be connected to a computer and used for web conferences, online calls, and other calls. Use the product for whichever of these purposes suits your needs.
- This section explains the operations which are the same for a USB connection and Bluetooth connection.

Talking on the phone

Use your device to make a phone call, referring to the device's user manual as necessary.

1 Turn on the product and place it on a desk or other surface.

2 Start the call.

- When the microphone detects a voice, the status indicator lamp in the voice input direction lights in green.
- When an outgoing or incoming call is ringing, the status indicator lamp will flash in white.

3 Operate using the product buttons.

Button	Explanation
Volume buttons	Increases/decreases the volume by 1 level. Press and hold to continually increase/decrease the volume. ^[1]
Mute button	Mutes the microphone. Press again to unmute. ^[2]
Talk button	Answers an incoming phone call when Bluetooth is connected. Press again to end the call. When an incoming phone call is ringing, press and hold (for about 2 seconds) to reject the call.

[1] When the volume is adjusted, the status indicator lamp lights in green according to the volume.

[2] When muted, the status indicator lamp lights in red.

Listening to music

This product can be used as a speaker. Use your device to start music playback, referring to the device's user manual as necessary.

1 Turn on the product and place it on a desk or other surface.

2 Start music playback on the connected device.

3 Operate using the product buttons.

Using the product

Button	Explanation
Volume buttons	Increases/decreases the volume by 1 level. Press and hold to continually increase/decrease the volume. ^[1]
Play/pause button	Starts music playback. Press again to pause. Press 2 times in succession to change to the next track. Press 3 times in succession to change to the previous track or return to the start of the current track.

[1] When the volume is adjusted, the status indicator lamp lights in green according to the volume.

Auto power off function

When the power is on and the Bluetooth connection is used, the product automatically turns off after 5 minutes of not being connected to a device.

Voice guidance

The product plays English voice guidance in the following situations.

Situation	Voice guidance
Power is turned on (USB connection)	Power on, USB mode
Power is turned on (Bluetooth connection)	Power on, Bluetooth mode
Power is turned off	Power off
Power is turned off due to low battery level	Please recharge, power off
Switching from Bluetooth connection to USB connection	USB mode
Bluetooth connection is possible	Bluetooth pairing
Bluetooth is connected	Bluetooth connected
Bluetooth is disconnected	Bluetooth disconnected
Battery level is low	Low battery

Cleaning

Get into the habit of regularly cleaning the product to ensure that it will last for a long time. Do not use alcohol, paint thinners, or other solvents for cleaning purposes.

- Use a dry cloth to clean the body.
- Immediately wipe off any moisture such as sweat from operating areas such as the buttons. Failure to do so may result in a malfunction due to corrosion.
- Wipe away any perspiration or dirt from the cable with a dry cloth immediately after use. Failure to clean the cable may cause it to deteriorate and harden over time, resulting in malfunction.
- Wipe the cable's USB plug with a dry cloth if dirty.



- If the product will not be used for an extended period of time, store it in a well-ventilated place free from high temperatures and humidity.

Resetting

If the product operates abnormally (reset)

When using a Bluetooth connection, reset the product if it cannot be unpaired, connected, or does not operate as expected.

1 When the USB cable is disconnected, press and hold the power button (for about 2 seconds) to turn on the power.

2 Press and hold the pairing button (for about 8 seconds).

- Continue pressing and holding the button until the voice guidance plays the message "Power off", and the power automatically turns off.
- While the button is being pressed, the status indicator lamp will flash in red.

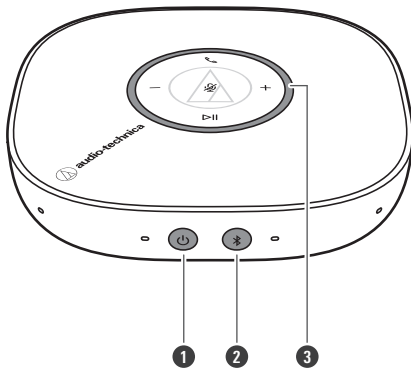

- ① Power button
- ② Pairing button
- ③ Status indicator lamp

3 Turn on the power again to complete reset.

4 Delete the registration of this product from the smartphone, computer, or other Bluetooth device side, and then perform pairing again.



- If the procedure cannot be completed as expected, repeat the procedure from the beginning.

Troubleshooting

? Power is not supplied

- Charge the product.

? Unable to pair

- Confirm that the Bluetooth device communicates using Ver. 2.1+EDR or higher.
- Place the product and the Bluetooth device within 1 m (3.3') of each other.
- Set the profiles for the Bluetooth device. For procedures on how to set profiles, refer to the Bluetooth device's user manual.
- Remove the pairing information for the Bluetooth device then pair the product with this device again.
- When switching to a new Bluetooth device, you may not be able to pair because the previously connected Bluetooth device cannot be disconnected. In this case, press the pairing button. The product will switch to the "searching for devices" state and you will be able to pair with your desired Bluetooth device.

? Cannot hear your own voice / Your own voice is too quiet

- Connect the product before starting a web conference or online call.
- Switch the sound input of the connected device or call app to the product.
- Turn up the volume of microphone input on the connected device.

? Cannot hear the voice of the caller / Voice of the caller is too quiet

- Turn on the power of the product and the connected device.
- Switch the sound output of the connected device or call app to the product.
- Turn up the volume on the product and the connected device.

? Cannot hear the voice of the caller / Voice of the caller is too quiet (when Bluetooth is connected)

- Confirm that the product and Bluetooth device are connected via HFP (or phone connection).
- Disable pairing for the product and the Bluetooth device, then pair the product with this device again.

? No sound is heard / Sound is faint

- Turn on the power of the product and the connected device.
- Turn up the volume on the product and the connected device.
- Switch the sound output of the connected device to the product.

No sound is heard / Sound is faint (when Bluetooth is connected)

- Make sure that the product and Bluetooth device are connected by the A2DP (or audio connection).
- Disable pairing for the product and the Bluetooth device, then pair the product with this device again.
- Move away from obstacles between the product and the Bluetooth device, such as people, metal, or walls, and place the product and device closer together.

Sound is distorted / Noise is heard / Sound cuts out

- Turn down the volume on the product and the connected device.
- Keep the product away from devices that emit radio waves such as microwaves and wireless routers.
- Keep the product away from TVs, radios, and devices with built-in tuners. These devices can also be affected by the product.
- Turn off the equalizer settings of the Bluetooth device.
- Remove obstacles between the product and the Bluetooth device and place them closer together.

The product cannot be charged

- Securely connect the included USB cable and charge the product.
- Charge the product in a well-ventilated place (10 to 35°C (50 to 95°F)) away from direct sunlight.



- For details about how to operate your Bluetooth device, refer to the device's user manual.

Specifications

Amplifier and speaker

Type	Speaker system with built-in amplifier
Speaker unit	44 mm/Full range
Sensitivity	90±2 dB
Frequency response	250 to 18,000 Hz
Maximum output	3 W
Impedance	4 ohms

Microphone

Type	MEMS type
Polar pattern	Omnidirectional
Sensitivity	-26 dB (1 V/Pa, at 1 kHz)
Frequency response	60 to 7,000 Hz

Communication specifications (USB)

System requirements	USB 2.0
Supported operating systems	Windows 8.1, Windows 10, macOS Catalina, macOS Big Sur
Bit depth	Maximum 16 bit
Supported sample rates	48 kHz

Communication specifications (Bluetooth)

Communication system	Bluetooth version 5.0
Maximum RF output	10 mW EIRP
Maximum communication range	Line of sight - approx. 10 m (33')
Frequency band	2.4 GHz band (2.402 GHz to 2.480 GHz)
Modulation method	FHSS
Compatible Bluetooth profiles	A2DP, AVRCP, HFP
Supported codec	SBC
Supported content protection method	SCMS-T
Transmission band	20 to 20,000 Hz

Specifications

Other

Power supply	DC 3.6 V lithium ion battery (built-in)
Charging specifications	5 V  1.3 A ^[1]
Charging time	Approx. 5 hours ^[2]
Operating time	Continuous transmission time (phone call): Max. approx. 15 hours ^[2]
Input jack	USB Type-C jack
Dimensions	30.5 mm (1.2") × 122 mm (4.8") × 122 mm (4.8") (H×W×D)
Weight	Approx. 325 g (11.5 oz)
Operating temperature	5°C to 40°C (41°F to 104°F)
Included accessories	USB cable (1.0 m (3.3')), USB Type-A - USB Type-C), USB cable (1.0 m (3.3')), USB Type-C - USB Type-C), Case

[1] When using a commercially available AC adapter, use a product with a rated current of 1.3 A or higher.

[2] The figures above depend on the operating conditions.

- For product improvement, the product is subject to modification without notice.

Trademarks

- The **Bluetooth**[®] word mark and logos are registered trademarks owned by Bluetooth SIG, Inc., and any use of such marks by Audio-Technica Corporation is under license. Other trademarks and trade names are those of their respective owners.
- USB Type-C[™] is a trademark of USB Implementers Forum.
- Microsoft[®] and Windows[®] are registered trademarks of Microsoft Corporation in the United States and/or other countries.
- Microsoft Windows operating system is indicated in its abbreviated form as Windows.
- Mac and macOS are trademarks of Apple Inc., registered in the U.S. and other countries and regions.

株式会社オーディオテクニカ

〒194-8666 東京都町田市西成瀬2-46-1
www.audio-technica.co.jp

Audio-Technica Corporation

2-46-1 Nishi-naruse, Machida, Tokyo 194-8666, Japan
www.audio-technica.com
©2021 Audio-Technica Corporation
Global Support Contact: www.at-globalsupport.com